



FAG

2208-K-2RS-TVH-C3

Self-aligning ball bearing

Schaeffler ID:
0384725700030Self-aligning ball bearing 22..-K-2RS-TVH,
tapered bore taper 1:12, seals, plastic
cage

Technical information

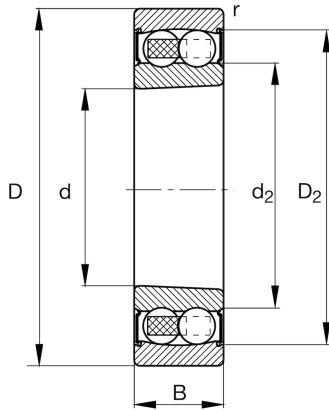

Main Dimensions & Performance Data

| | | |
|------------|-------------|-----------------------------------|
| d | 40 mm | Bore diameter |
| D | 80 mm | Outside diameter |
| B | 23 mm | Width |
| r_{\min} | 1,1 mm | Minimum chamfer dimension |
| C_r | 19.400 N | Basic dynamic load rating, radial |
| C_{0r} | 6.500 N | Basic static load rating, radial |
| C_{ur} | 415 N | Fatigue load limit, radial |
| n_G | 4.950 1/min | Limiting speed |
| | 0,486 kg | Weight |

Dimensions

| | | |
|-------|---------|-----------------------------|
| D_2 | 70,3 mm | Caliber diameter outer ring |
| d_2 | 49,2 mm | Caliber diameter inner ring |

Mounting dimensions

| | | |
|--------------|-------|---------------------------------------|
| $d_{a \min}$ | 47 mm | Minimum diameter shaft shoulder |
| $d_{a \max}$ | 52 mm | Maximum diameter shaft shoulder |
| $D_{a \max}$ | 73 mm | Maximum diameter of housing shoulder |
| $d_{b \min}$ | 43 mm | Minimum cavity diameter of the sleeve |
| $B_{a \min}$ | 5 mm | Minimum cavity width of the sleeve |
| $r_{a \max}$ | 1 mm | Maximum fillet radius |

Calculation factors

| | | |
|-------|------|---|
| e | 0,22 | Limiting value of F_a/F_r for the applicability of diff. Values of factors X and Y |
| Y_1 | 2,91 | Dynamic axial load factor |
| Y_2 | 4,51 | Dynamic axial load factor |
| Y_0 | 3,05 | Static axial load factor |

Additional information

| | |
|------|----------------|
| H308 | Adapter sleeve |
|------|----------------|

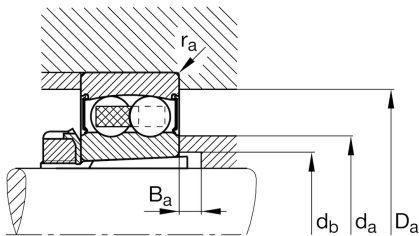
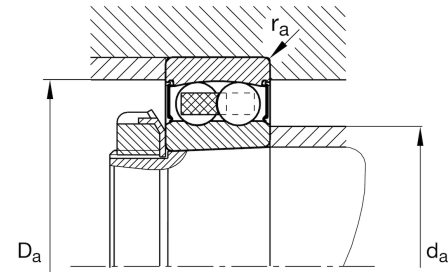

Temperature range

| | | |
|------------------|--------|----------------------------|
| T _{min} | -20 °C | Operating temperature min. |
| T _{max} | 100 °C | Operating temperature max. |